



SUBMITTAL

## FFXA-FF-SERIES

FULL-FLOW WELL WATER & PRESSURE  
BOOSTER EXPANSION TANKS

**Models:** FFXA 85-FF thru FFXA 800L-FF

**Rev.** 1 4/8/2020

Job Name _____ Location _____ _____ Engineer _____ Contractor _____ Sales Rep. _____	Submitted By _____ Date _____ Approved By _____ Date _____ Order No. _____ Date _____ Notes _____ _____ _____
---	--

### Description

Flexcon patented type FFXA-FF tanks are ASME replaceable bladder type pre-charged Full-Flow well water and pressure booster hydro-pneumatic expansion tanks. The FFXA-FF is designed as a multi-functional bladder tank for controlling system pressures between pump cycles to provide sufficient flow to meet demands. The FFXA-FF design incorporates a unique flow-through design that promotes fluid mixing. Mixing of the fluid inside the bladder tank disrupts stagnant water, preventing growth of potentially harmful bacteria colonies. The water is contained in a heavy-duty butyl bladder, preventing tank corrosion and waterlogging. Products comply with NSF/ANSI Standard 61.

### Construction:

Shell: Carbon Steel  
 Heads: Carbon Steel  
 Exterior: Carbocoat 140 - Harvester Red  
 Bladder: Heavy-duty Butyl (FDA Approved)  
 System Connection: Stainless Steel

### Performance Limitations

Maximum Design Temperature: 240°F  
 Maximum Design Pressure: 125 PSIG\*

\*150, 200 & 250 PSIG available



Model Number	Wessels Model	Tank Volume (Gal/L)	Tagging Information	Quantity
FFXA 85-FF	FXA-85	23/87		
FFXA 130-FF	FXA-130	35/132		
FFXA 200-FF	FXA-200	53/200		
FFXA 300-FF	FXA-300	79/299		
FFXA 400-FF	FXA-400	106/400		
FFXA 500-FF	FXA-500	132/500		
FFXA 600-FF	FXA-600	158/598		
FFXA 800L-FF	FXA-800L	211/798		

### Typical Specification

Furnish and install, as shown on plans, a \_\_\_\_\_ gallon \_\_\_\_\_" diameter X \_\_\_\_\_" (high) pre-charged steel hydro-pneumatic tank. The tank is to incorporate a flow through design, eliminating water stagnation potential. The tank shall be equipped with NPT stainless steel system connections, and a 0.302"-32 charging valve connection (standard tire valve) to facilitate the on-site charging of the tank to meet system requirements. The tank shall be fitted with lifting rings and a floor mounting skirt for vertical installation. The tank must be constructed with most recent addendum of Section VIII of the ASME Boiler and Pressure Vessel Code and stamped for 125 psi. Products comply with NSF/ANSI Standard 61.

Each tank shall be Wessels model number FFXA- \_\_\_\_\_-FF or approved equal.

**FFXA-FF-SERIES**  
FULL-FLOW WELL WATER & PRESSURE  
BOOSTER EXPANSION TANKS

Models: FFXA 85-FF thru FFXA-800L-FF

Rev. 1 4/8/2020

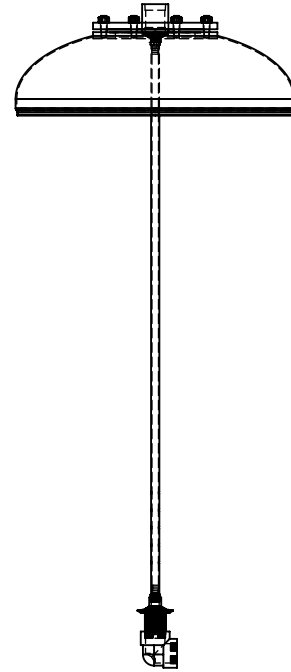
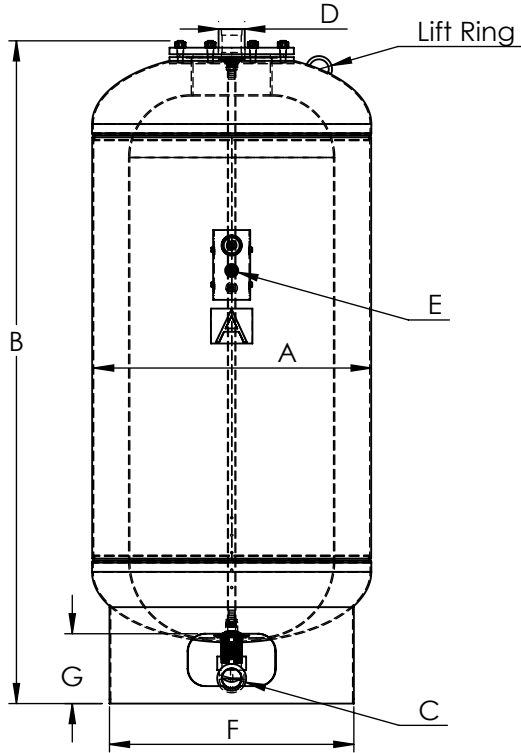

Full-Flow Internal

**Dimensions & Weights:**

Model Number	Dimensions in Inches/mm						Approx. Shipping Weight (lbs)	
	A	B	System Connection		Charging Valve	F		G
			C	D				
FFXA-85	16/406	37/940	1"/25mm NPT	1"/25mm NPT	0.302"-32NC	12/305	5 1/2/	90/41
FFXA-130	20/508					16/406		125/57
FFXA-200	24/607	43/1092	1 1/2"/32mm NPT	1 1/2"/32mm NPT		20/508	5 1/4 /	210/95
FFXA-300		55/1397				225/102		
FFXA-400	30/762	49/1245	2"/51mm NPT	2"/51mm NPT		24/607		300/136
FFXA-500		57/1448						335/152
FFXA-600	65/1651	76/1930				28/711		360/163
FFXA-800L	32/813							475/215

**Notes:**

- Tanks are factory pre-charged at 40 psi and field adjustable.
- Available with WessGuard® Tank Monitoring System (EMS Compatible), or WessView Tank Integrity Indicator.
- Available with Mounting Clips.